

QUICK START GUIDE

VU200 VACUUM CLEANER

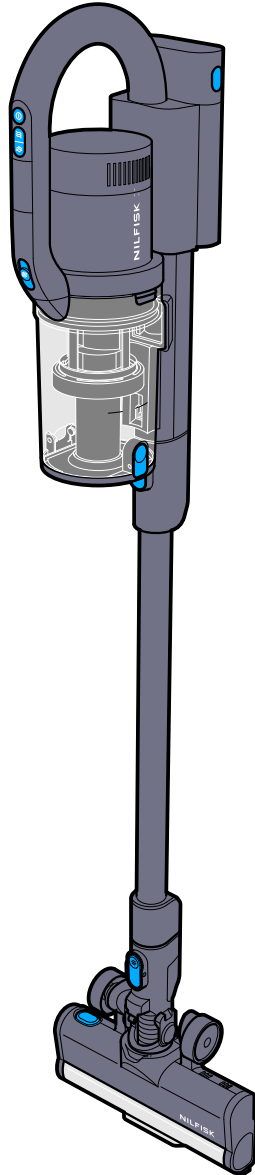

NILFISK

A



1

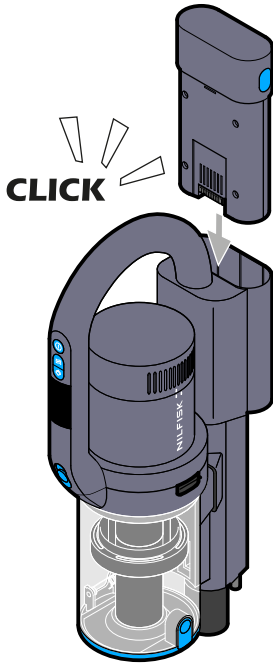

2

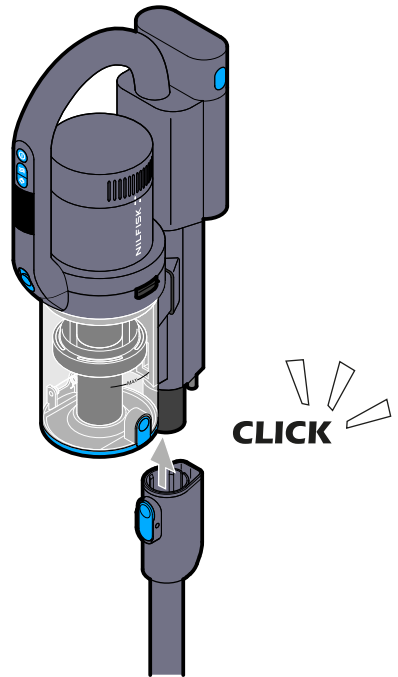

3

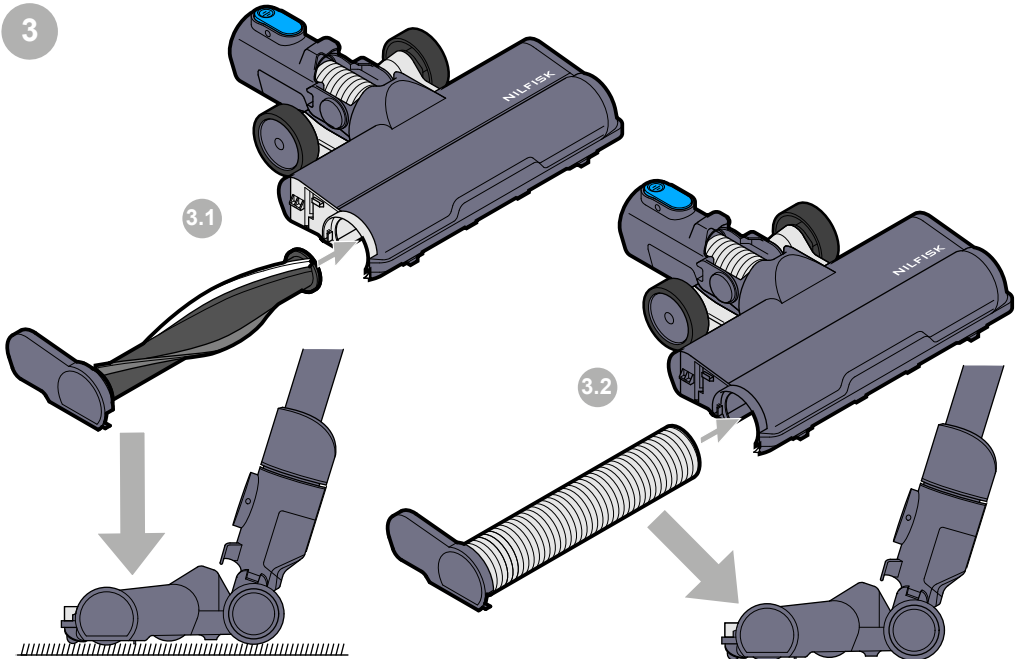

A



4

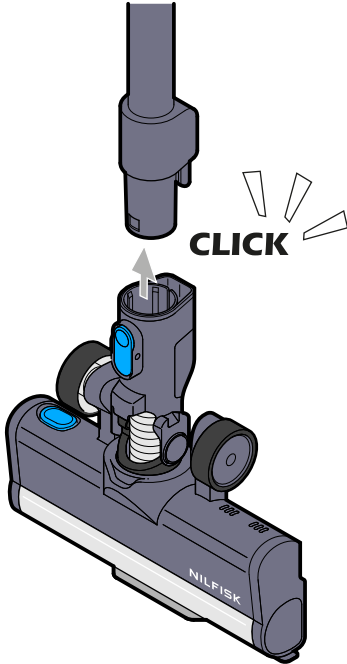

5

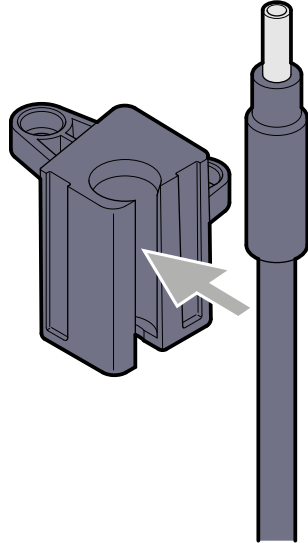

6

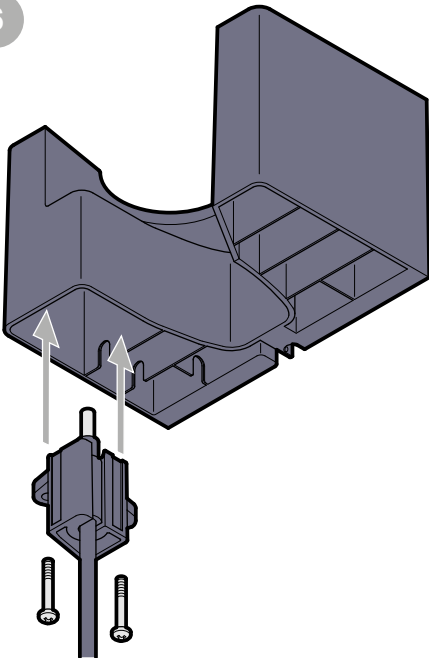

7

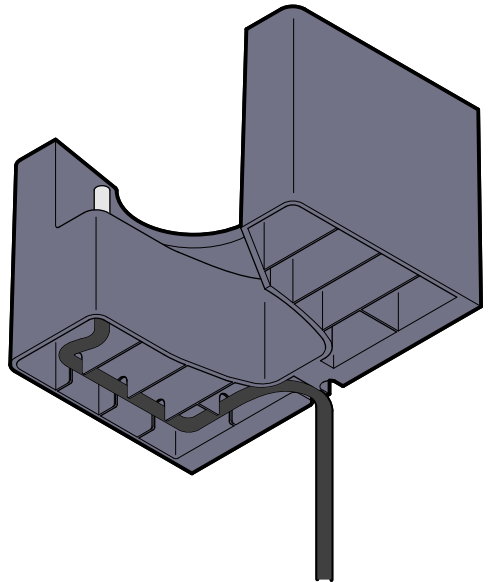

A



8

8.1

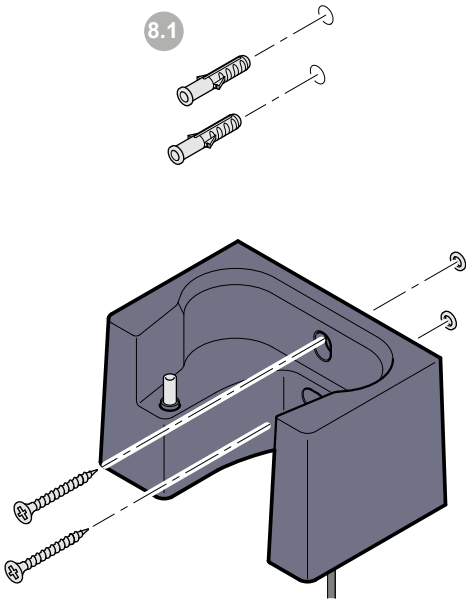

9

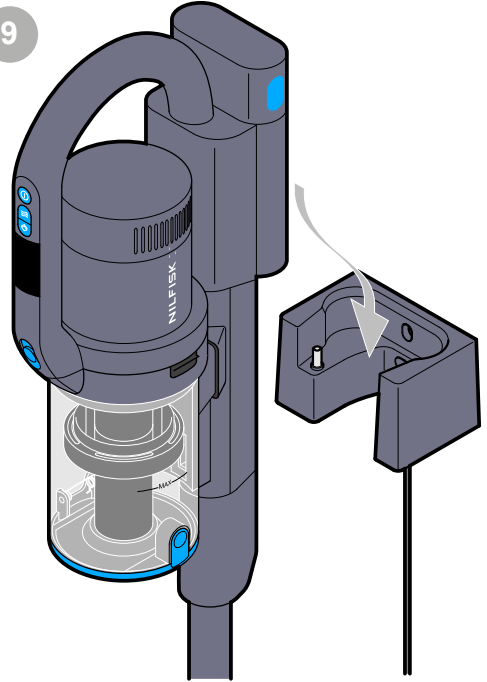

10

Round Extrusion

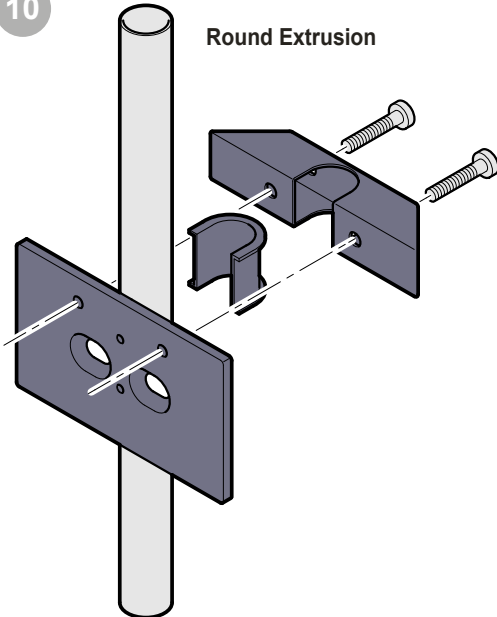

11

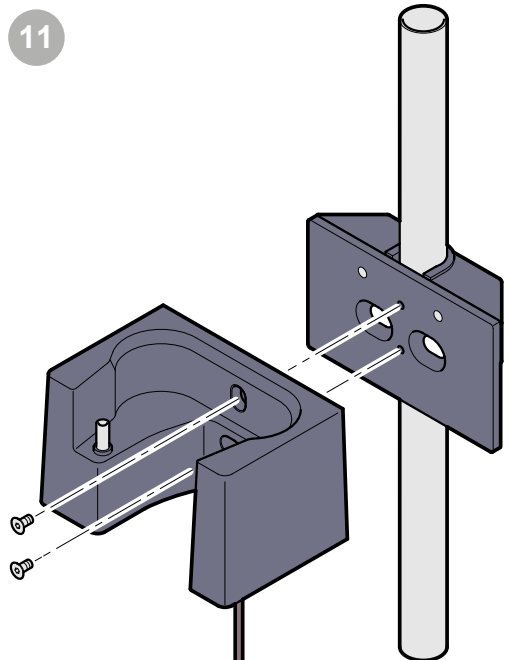

A



12

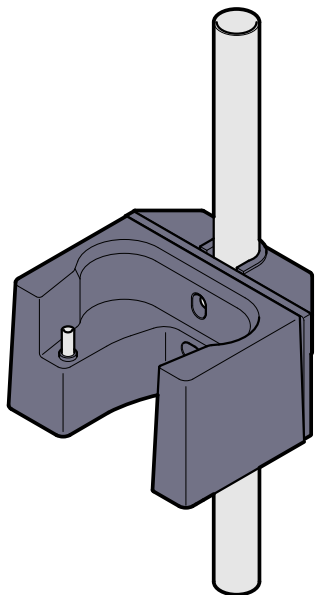

13

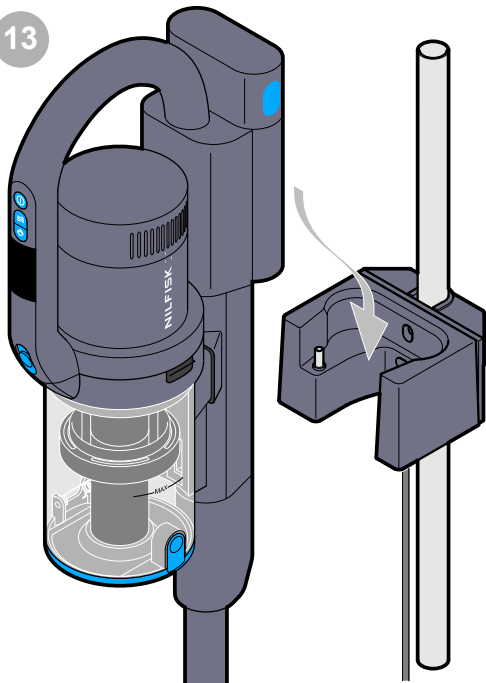

14

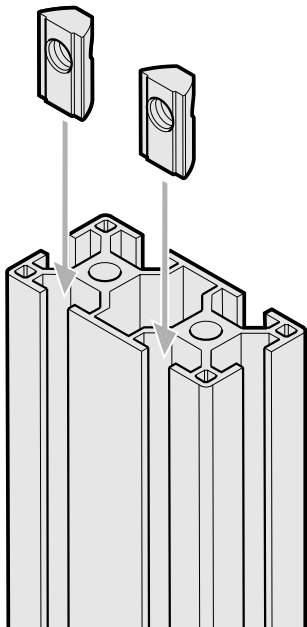

15

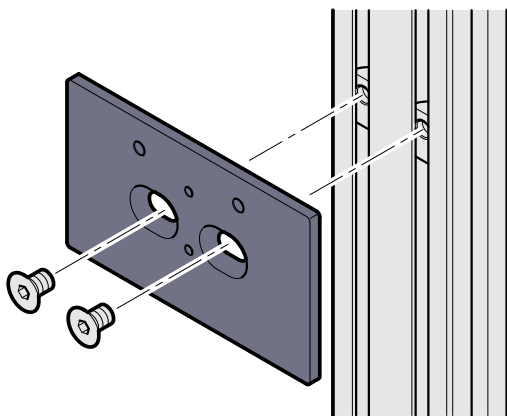

A



16

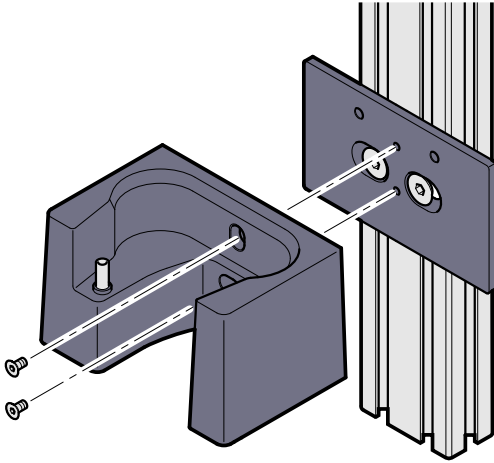

17

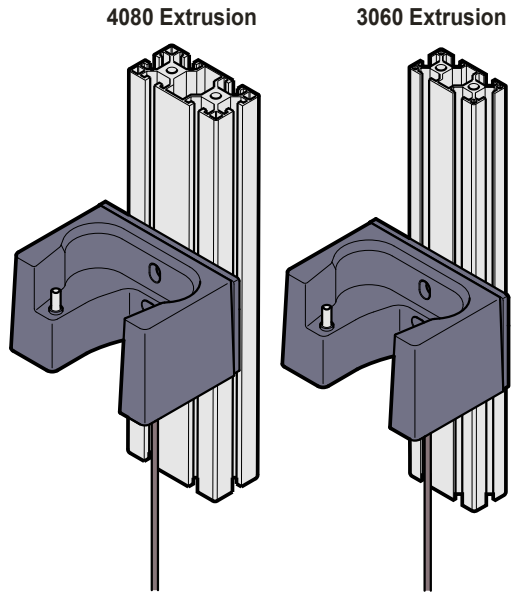

18

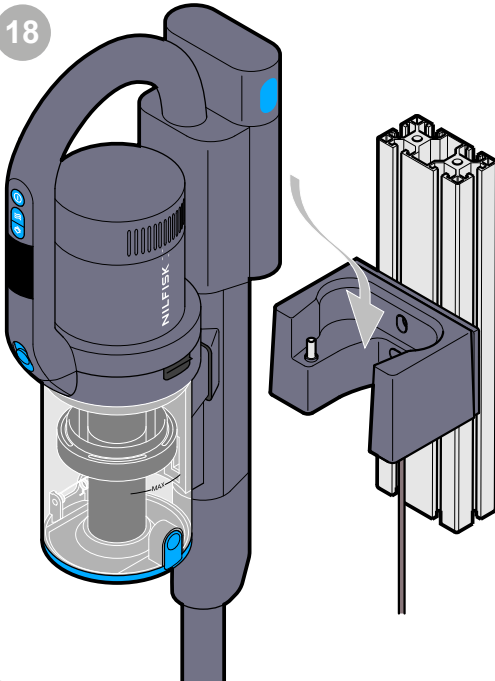

19

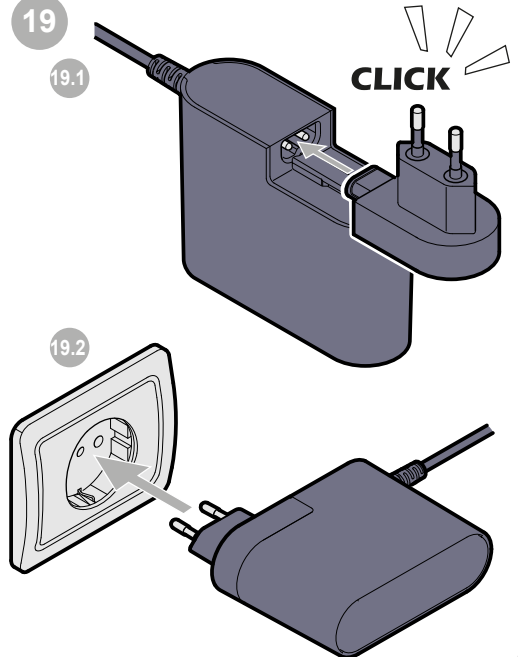

B



1

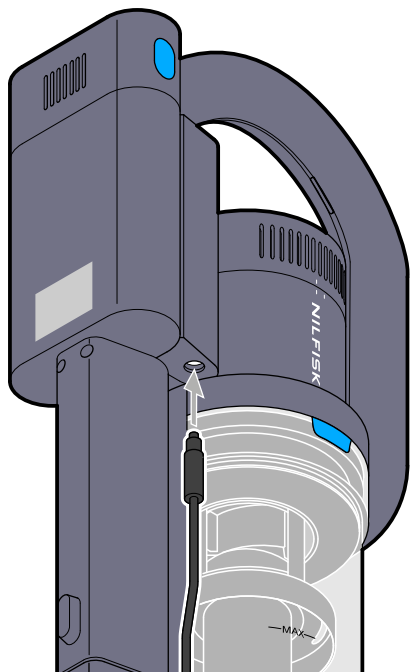

2

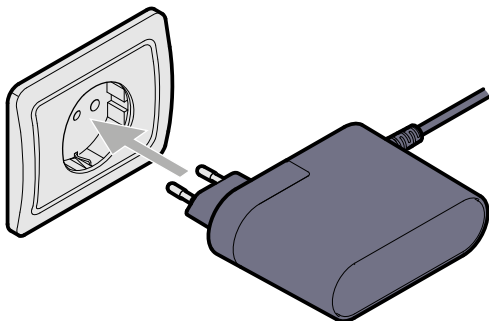

3

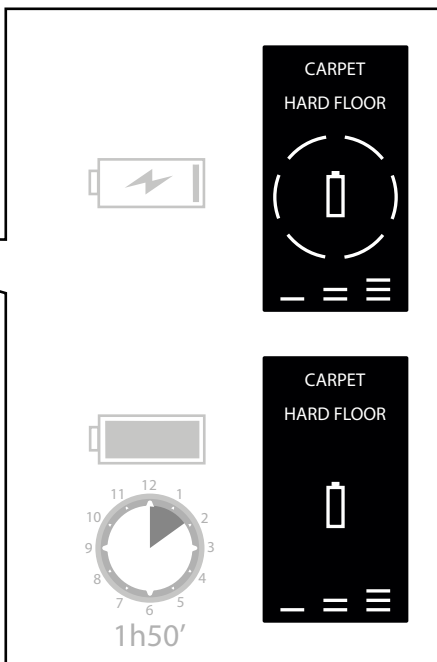
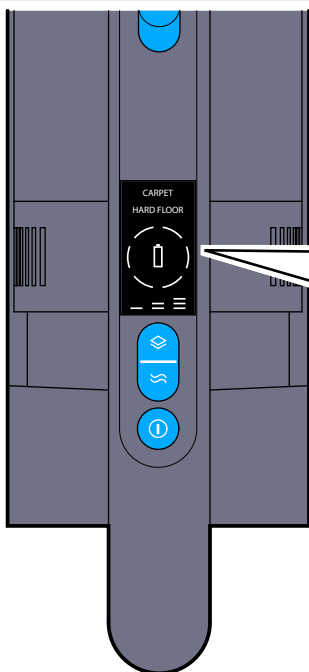

C



1

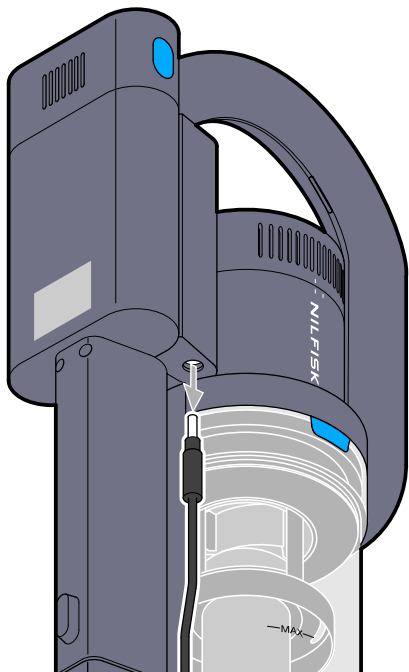

2

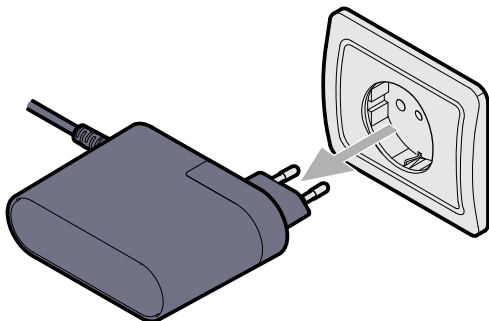

3

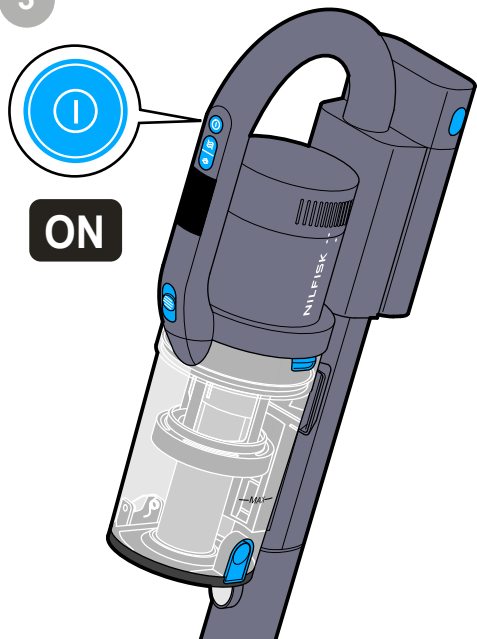

4

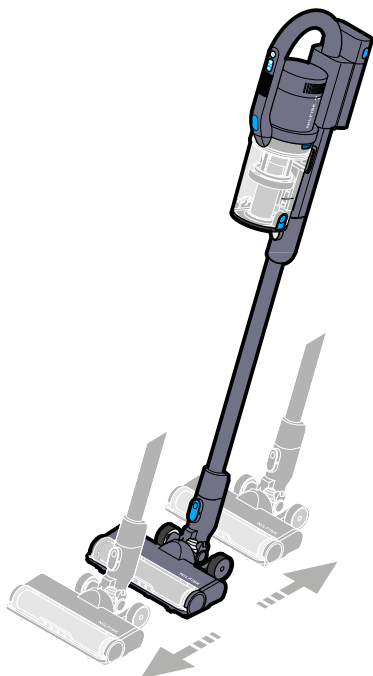

C



5

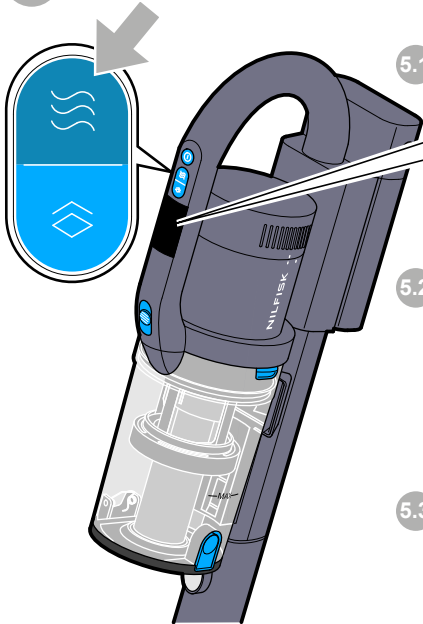

5.1



60min
ECO MODE

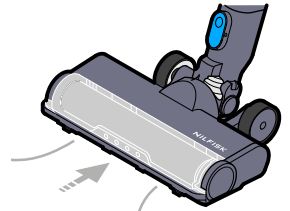

5.2



25min
NORMAL

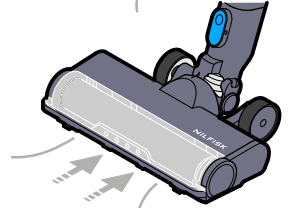

5.3

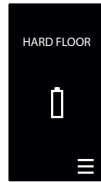

12min
TURBO

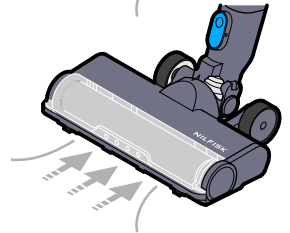

6

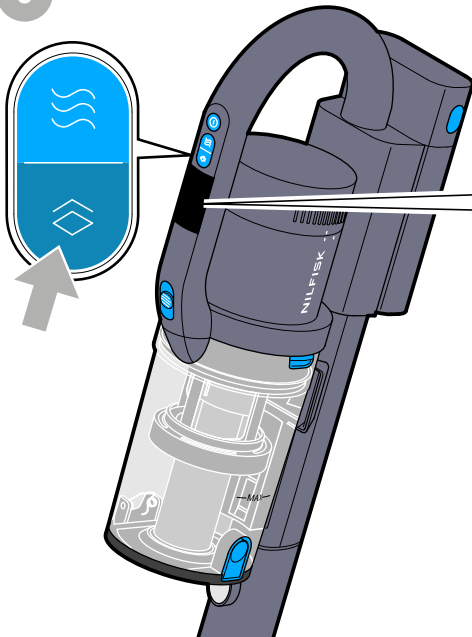

6.1

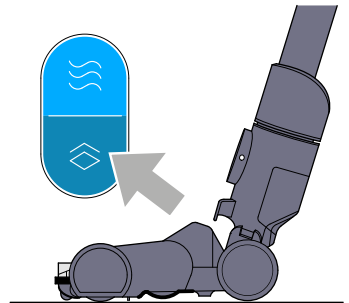

6.2

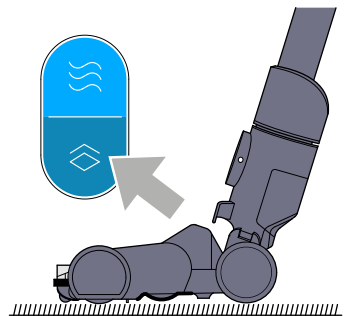

C



7

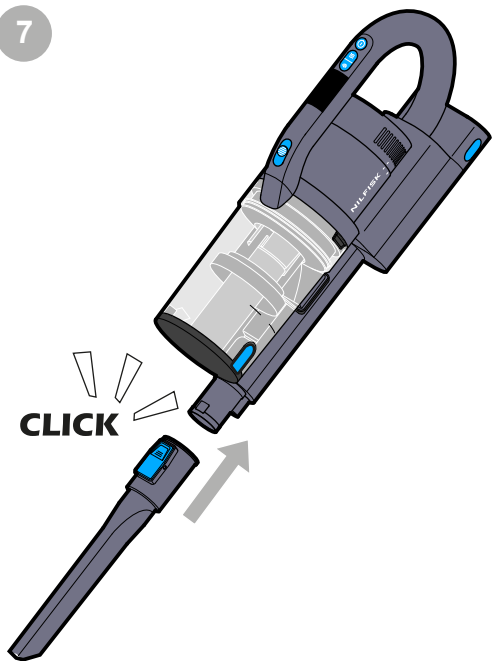

8

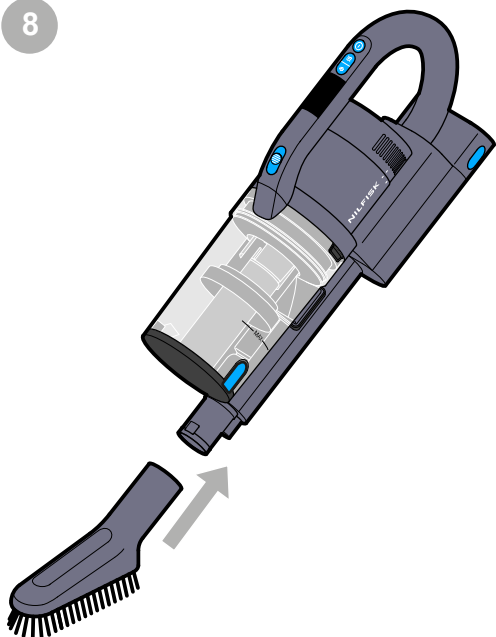

9

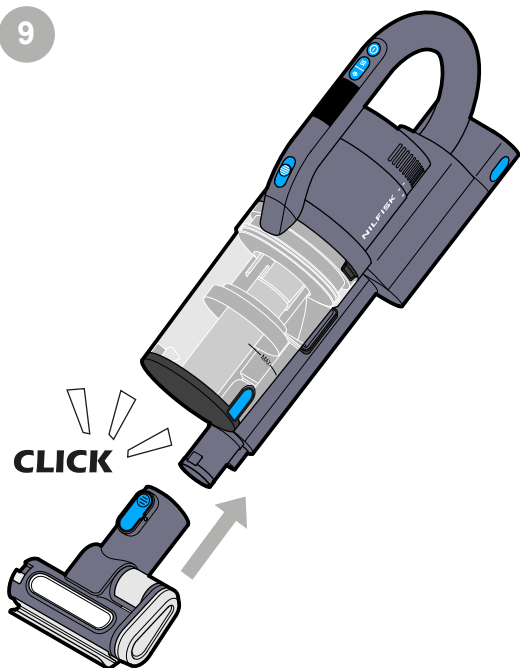

9.1

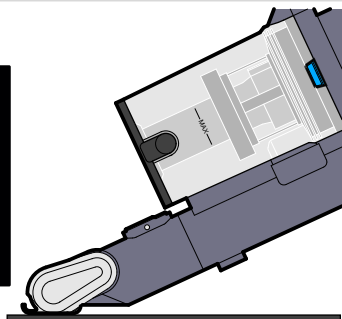
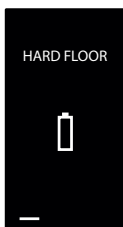

9.2

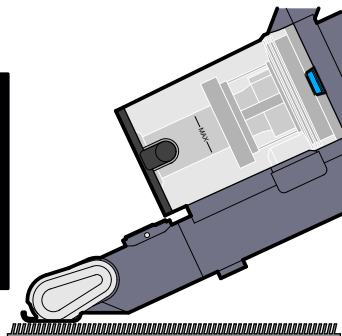
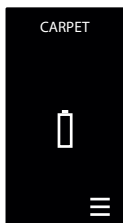

C



10

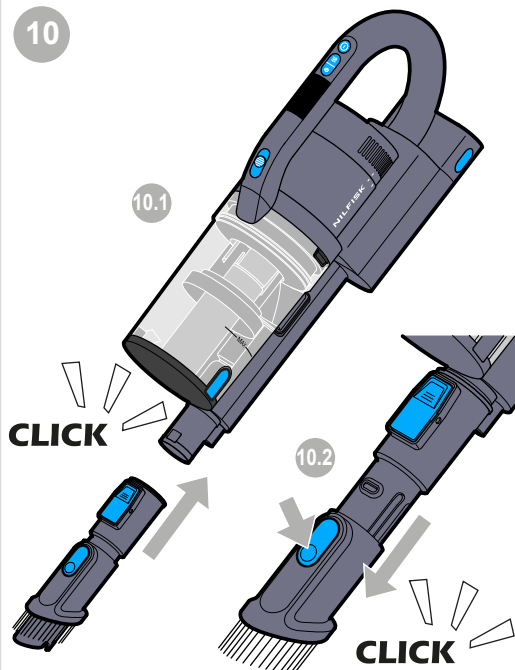

11

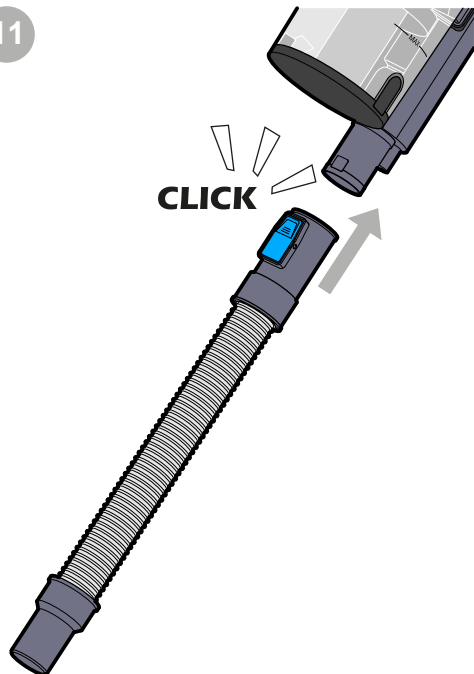

12

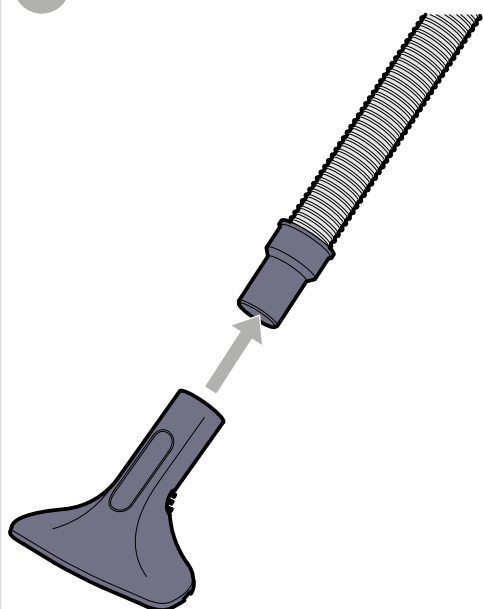

13

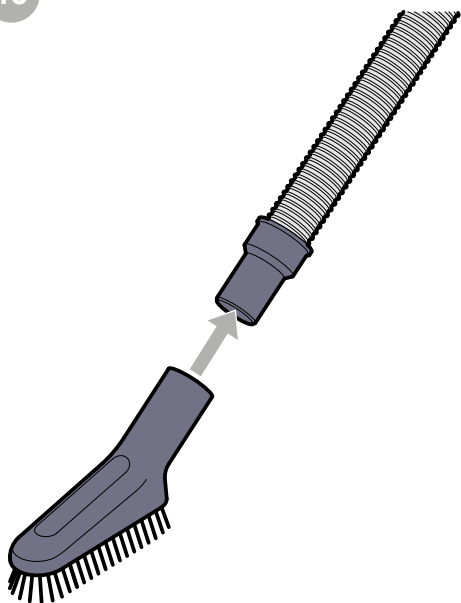



14

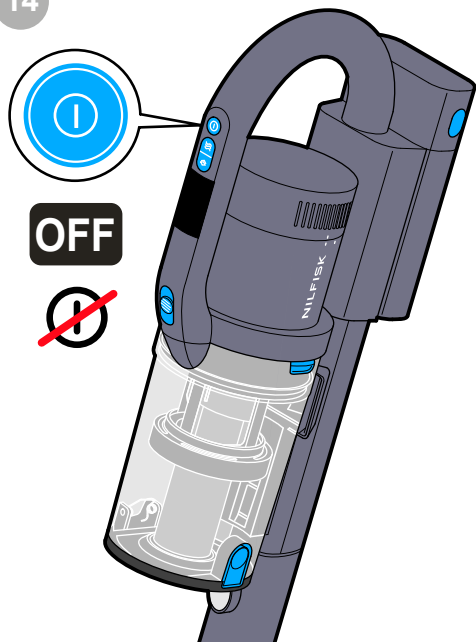

15

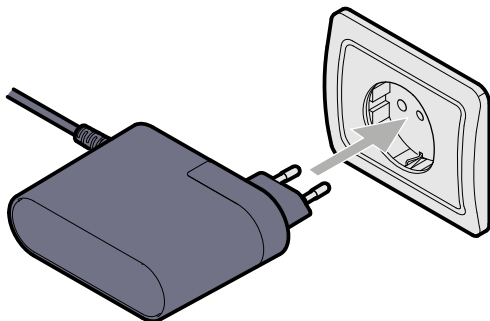

16

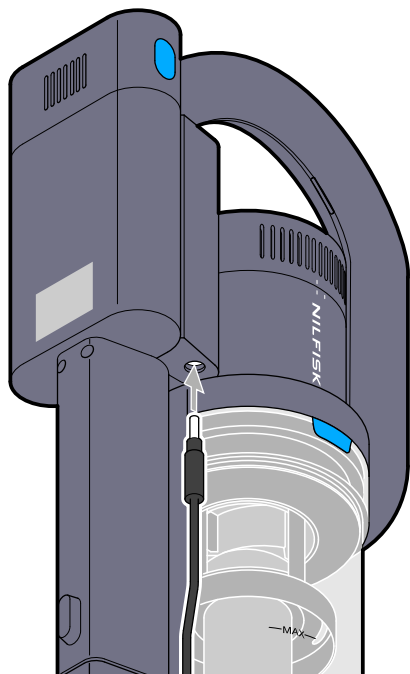

17

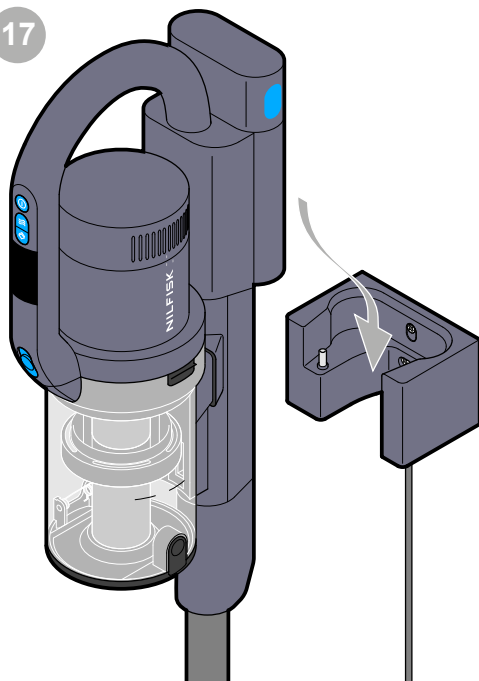

D



1

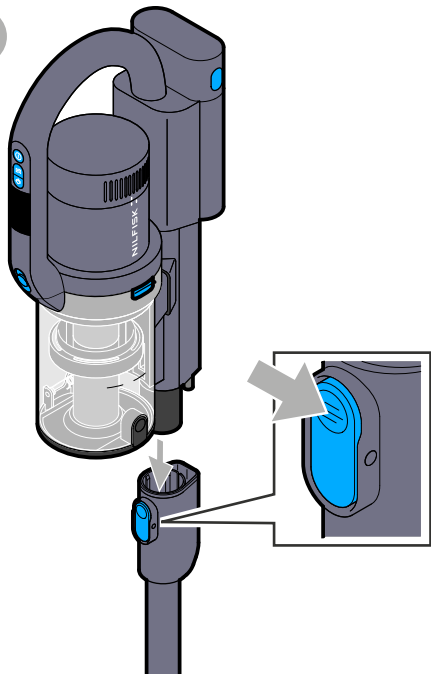

2

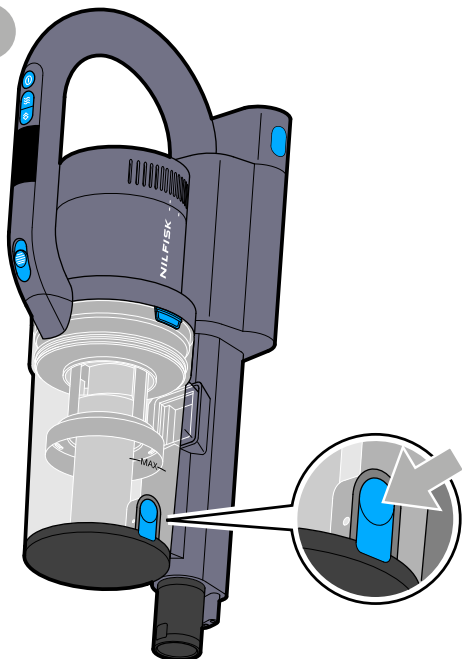

3

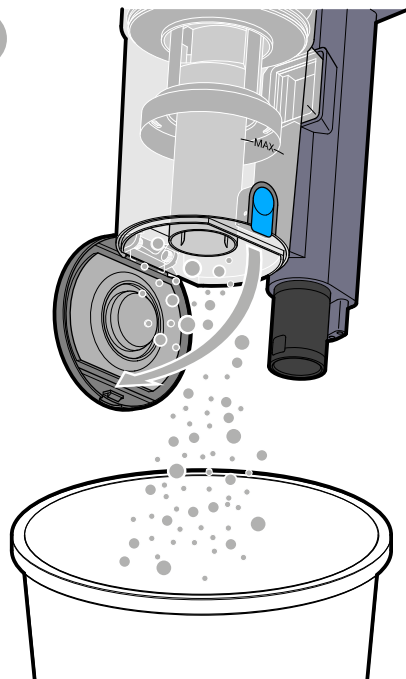

4

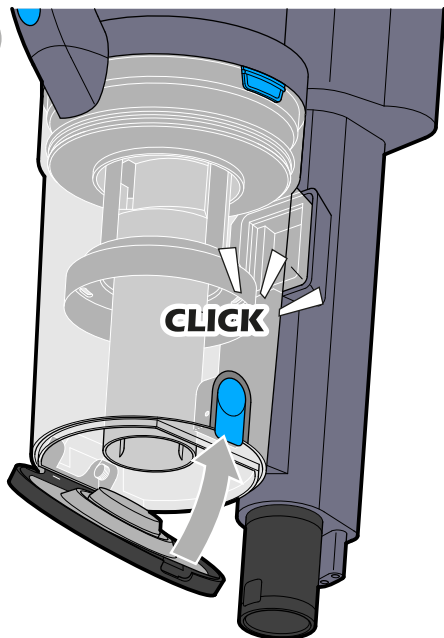



1

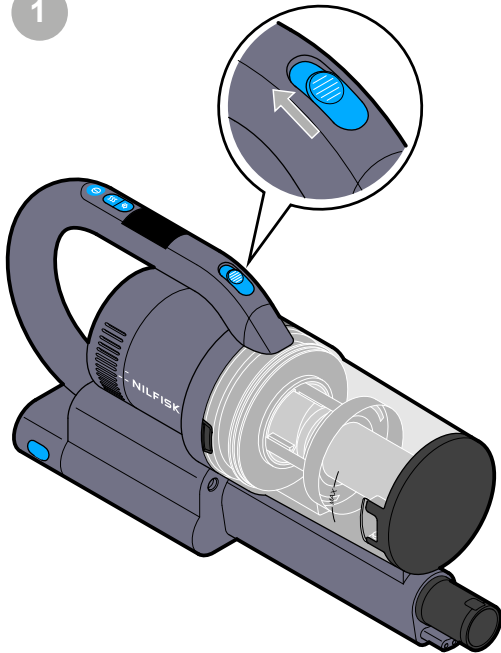

2

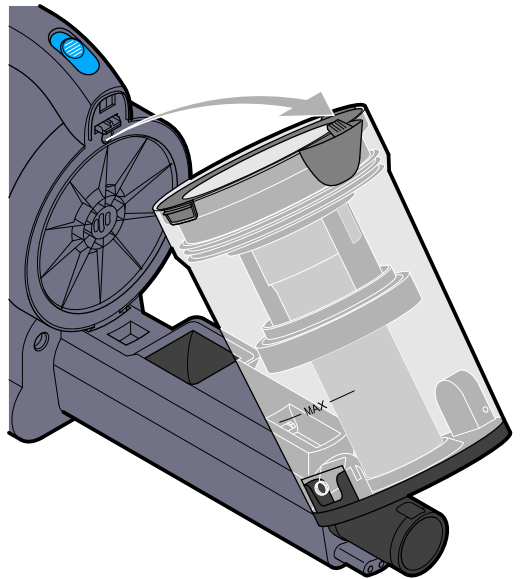

3

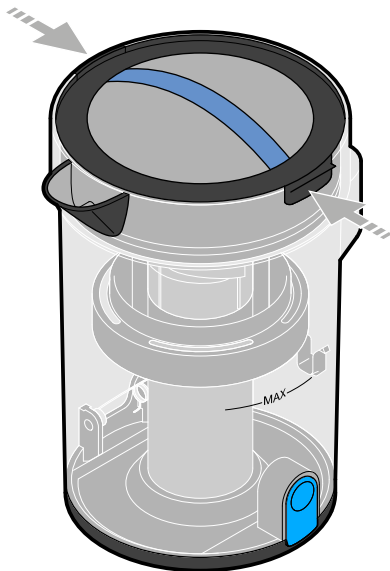

4

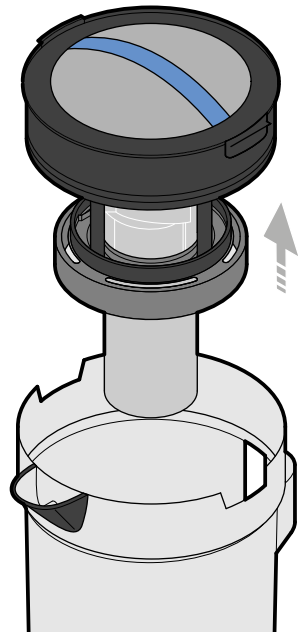

E



5

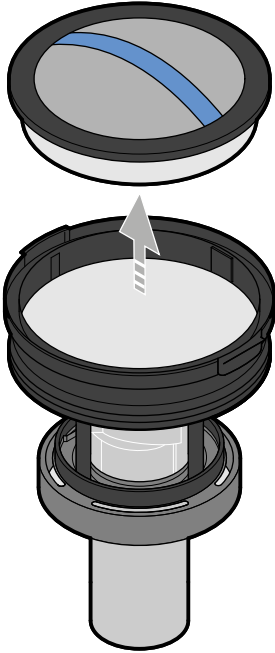

6

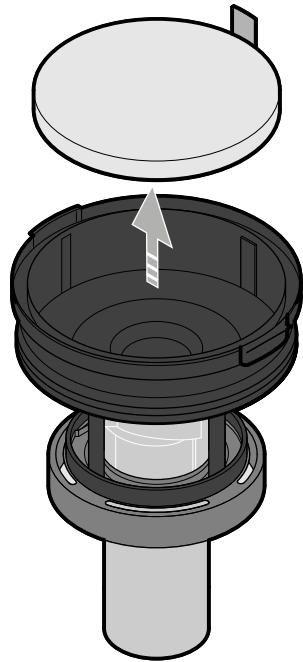

7

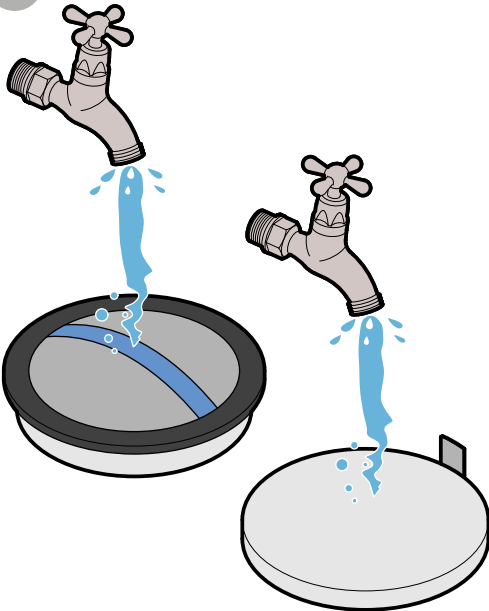

8

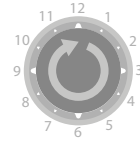

12hrs

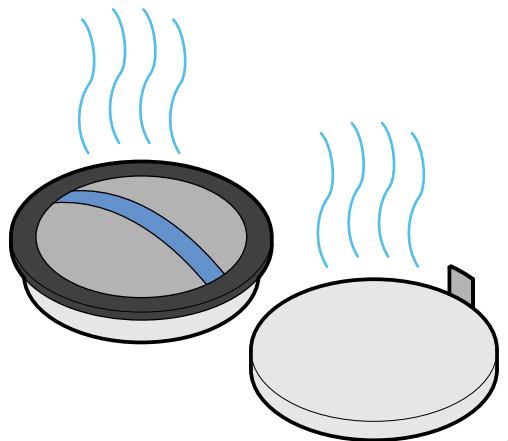
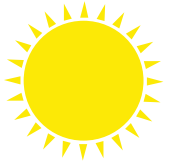

E



9

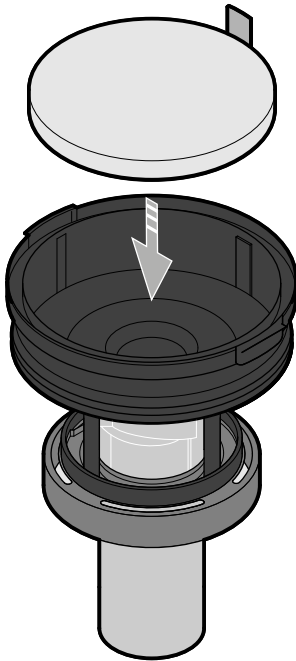

10

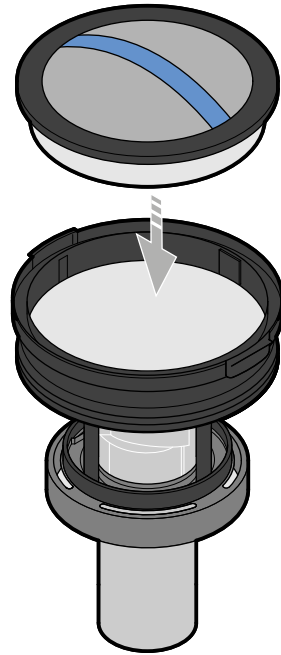

11

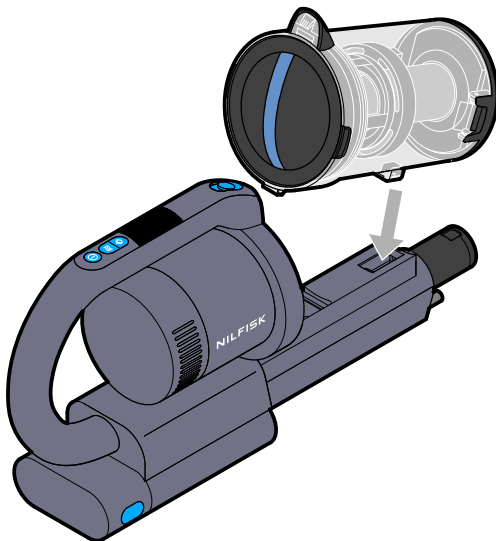

12

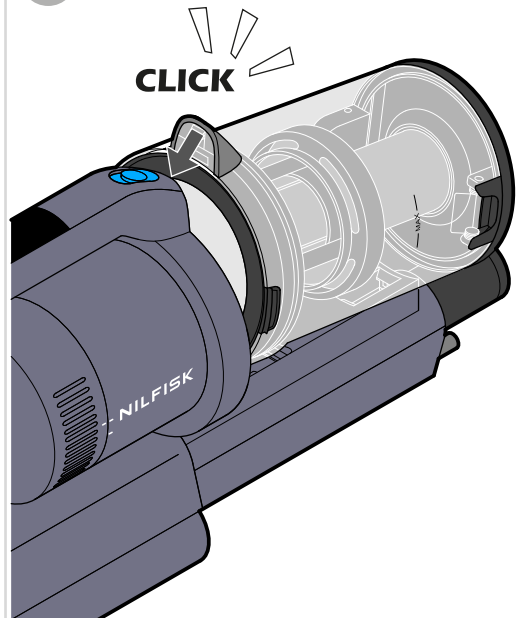



13

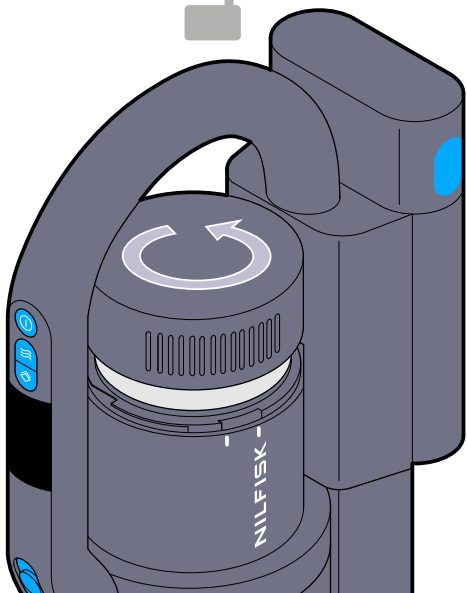

14

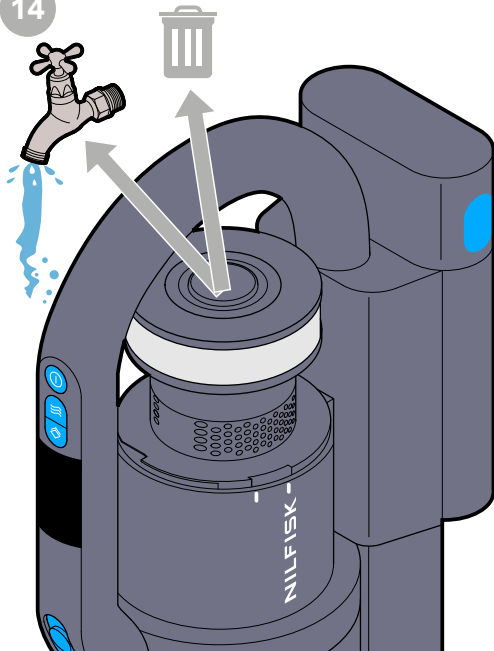

15

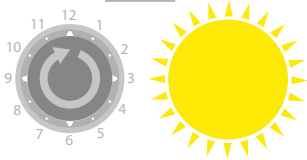

12hrs

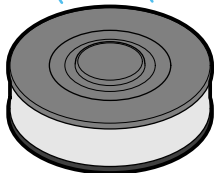
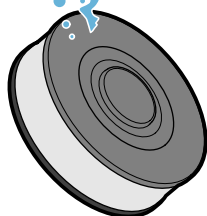
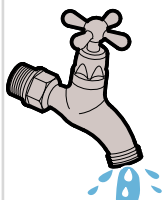

16

HEPA 14

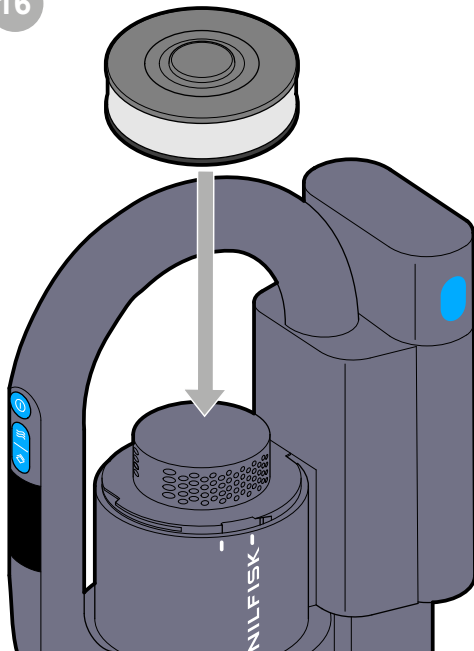



17

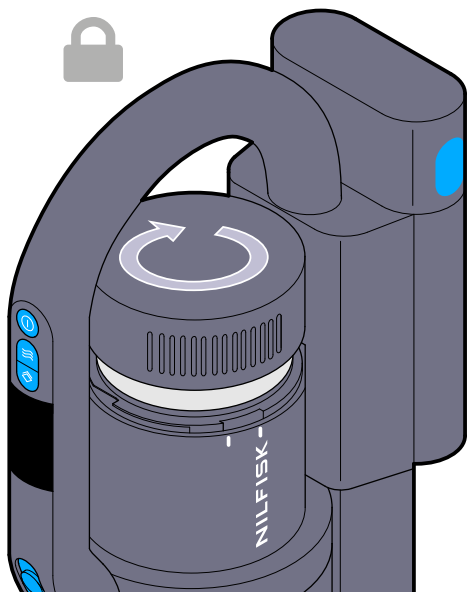

18

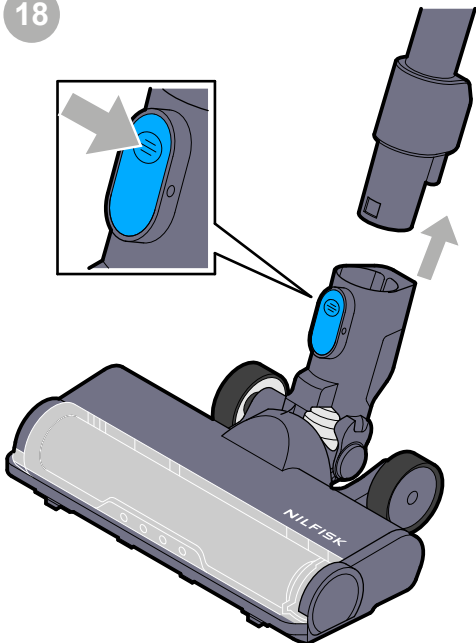
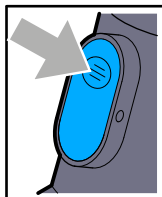

19

19.1

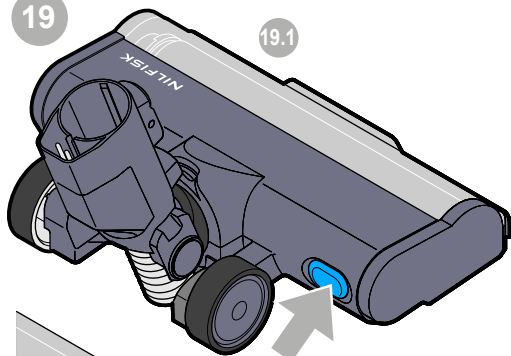

19.2

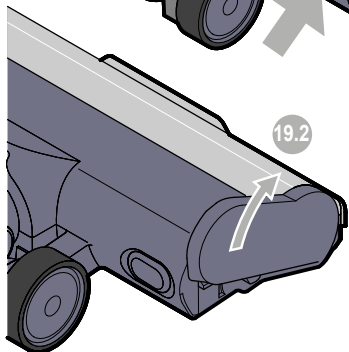

20

20.1

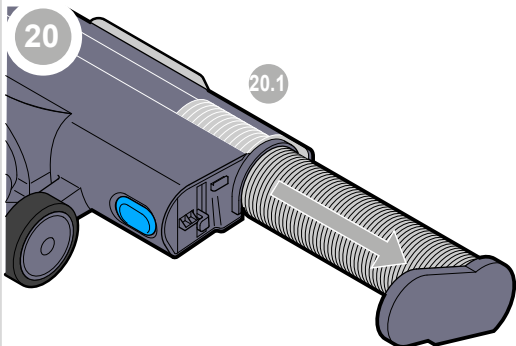

20.2

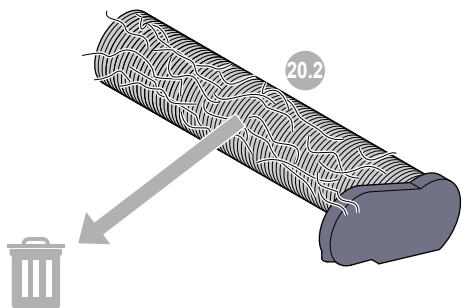



21

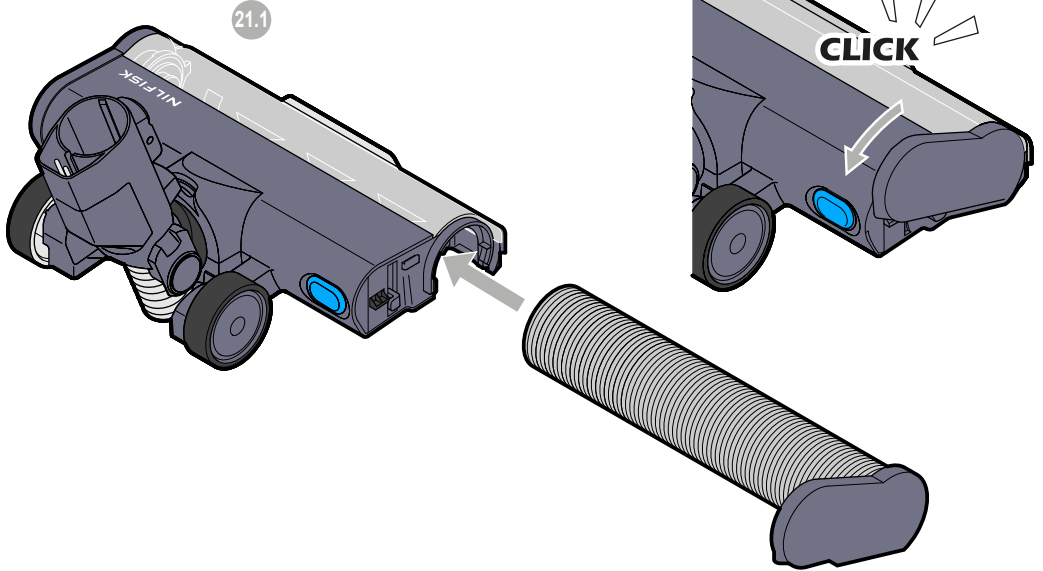

22

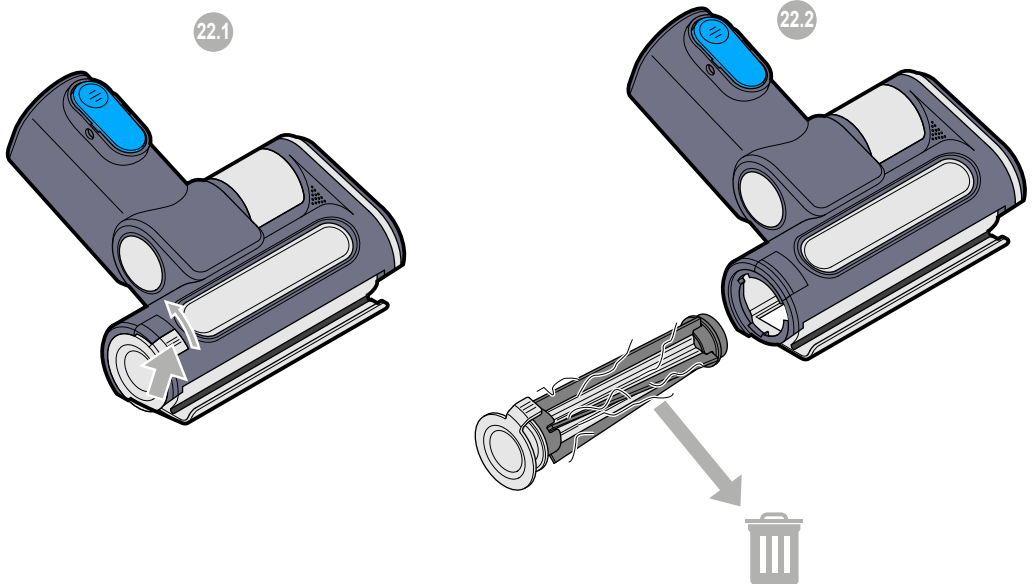



1

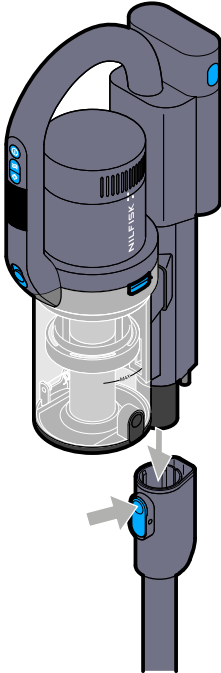

2

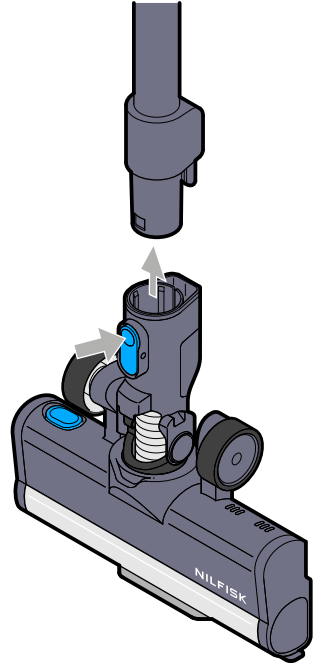

3

3.1

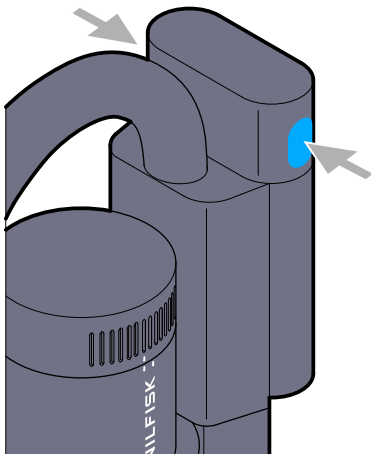

3.2

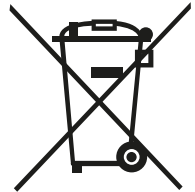
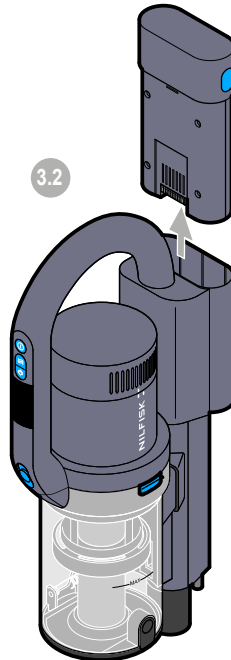

G



1

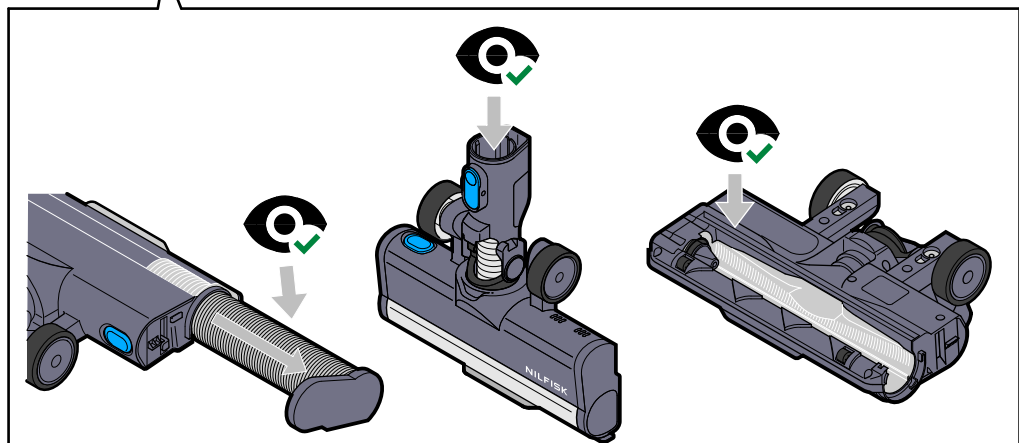
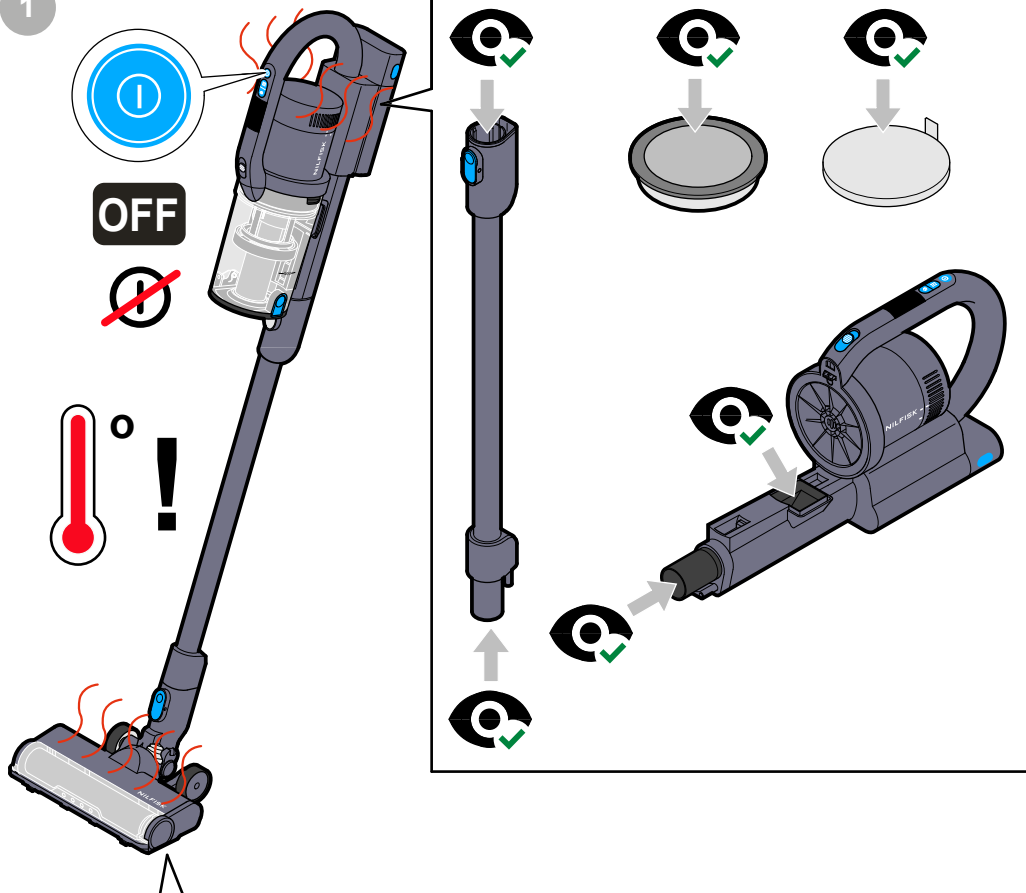

Spare parts

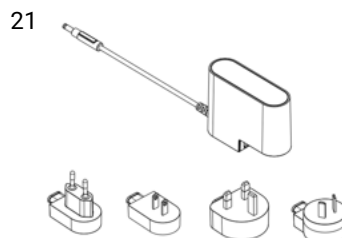
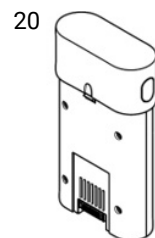
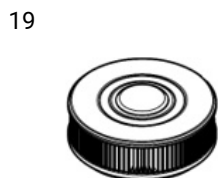
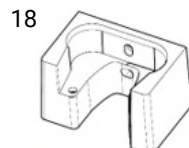
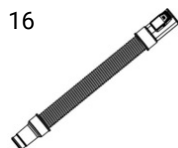
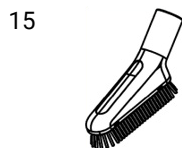
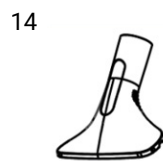
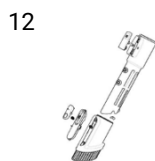
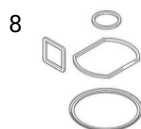
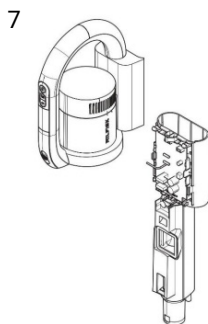
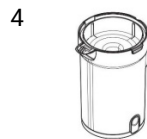
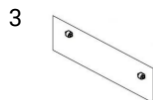
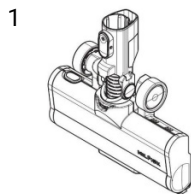

Safety Instructions (Original instructions)

 Before first use of the machine, read the instructions carefully. Failure to follow the warnings and instructions may result in electric shock, fire and/or serious injury. Save instructions for later use.

 Safety instructions marked with this symbol must be observed to prevent personal injury or serious damage to property.

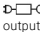
 This symbol means detachable power supply part. Part of the appliance the output of which is intended to be detachable from the class III construction part of the appliance.

Intended use

This machine is intended for commercial use, for example in hotels, schools, hospitals, factories, shops, offices and rental businesses.

WARNING!

This machine is not intended for use by persons (including children) with reduced physical, sensory or mental capabilities, or lack of experience and knowledge. Children should be supervised to ensure that they do not play with the appliance.

WARNING!

Operators shall be adequately instructed on the use of these machines.

WARNING!

Use only safety extra low voltage power supply provided with the appliance. This appliance contains batteries that are only replaceable by skilled persons. This machine is for dry use only. Do not use for wet pick-up. This machine is not intended for the suction of hazardous materials or gas, doing so may expose people to serious health risks. Do not pick up sharp objects such as needles or pieces of glass. Do not pick up anything that is burning or smoking such as cigarettes, matches or hot ashes. Do not use without filters in place. Do not use the machine if it appears faulty. Have the machine inspected by an authorized service center. If the machine has been dropped, damaged, left outdoors or has been exposed to water. No changes or modifications to the mechanical or electrical safety devices should be made. All repairs must be carried out by an authorized service center.

WARNING!

For the purposes of recharging the battery, only use the detachable supply unit provided with this appliance.

WARNING!

Risk Of Injury. Brush May Start Unexpectedly. Machine shall be disconnected from its power source before cleaning or maintenance and when replacing parts or converting the machine to another function: safely disconnecting at least the B+ or B- pole of the battery or an equivalent method (disconnecting device).

WARNING!

The vacuum cleaner must be disconnected from the charging station and batteries must be run flat before removing the battery pack. Press the release button to remove the battery pack from the unit.

WARNING!

Do not mutilate or incinerate the battery pack, as it will explode at high temperatures.

WARNING!

Risk of fire or serious injury: Never touch both terminals of a battery pack with metal objects and/or body parts as a short circuit may occur. Do not attempt to destroy or disassemble a battery pack or remove any of its components. Batteries must be recycled or disposed properly. Keep battery packs away from children.

WARNING!

Prevent unintentional starting. Ensure the switch is in the off-position before connecting to battery pack, picking up or carrying the appliance. Carrying the appliance with your finger on the switch or energizing appliance that have the switch on invites accidents. Disconnect the battery pack from the appliance before making any adjustments, changing accessories, or storing appliance. Such preventive safety measures reduce the risk of starting the appliance accidentally. When battery pack is not in use, keep it away from other metal objects, like paper clips, coins, keys, nails, screws or other small metal objects, that can make a connection from one terminal to another. Shorting the battery terminals together may cause burns or a fire. Under abusive conditions, liquid may be ejected from the battery; avoid contact. If contact accidentally occurs, flush with water. If liquid contacts eyes, additionally seek medical help. Liquid ejected from the battery may cause irritation or burns. Do not use a battery pack or appliance that is damaged or modified. Damaged or modified batteries may exhibit unpredictable behavior resulting in fire, explosion or risk of injury. Do not expose a battery pack or appliance to fire or excessive temperature. Exposure to fire or temperature above 130°C (266°F) may cause explosion. Follow all charging instructions and do not charge the battery pack or appliance outside of the temperature range specified in the instructions. Charging improperly or at temperatures outside of the specified range may damage the battery and increase the risk of fire. Have servicing performed by a qualified repair person using only identical replacement parts. This will ensure that the safety of the product is maintained. Do not modify or attempt to repair the appliance or the battery pack (as applicable) except as indicated in the instructions for use and care.

For use only with Battery VU200

For use only with charger S

Ambient temperature range for battery charging: 4°C~40°C

Ambient temperature range for battery use: -17°C~75°C

Ambient temperature range for battery storage: -20°C~25°C

CAUTION

This machine is for indoor use only.

CAUTION

This machine shall be stored indoors only.

Transportation

Only carry the machine by the handle. For transportation in vehicles, secure the machine against slipping and tilting in accordance with the valid guidelines.

Maintenance and care

Before all maintenance and care work, always remove the battery pack from the machine. All maintenance and repair work which requires the motor housing to be opened must always be carried out by an authorized service center. Always use original Nilfisk spare parts. Use impermeable bags to dispose of components that cannot be cleaned. Observe the applicable disposal provisions! Keep the contacts on machine, charger and battery pack clean.

Product disposal

Before discarding the product, the rechargeable battery pack must be removed and recycled in accordance with federal and local laws, as outlined below.

Liability

Nilfisk accepts no liability for any damage resulting from any improper or wrongful use. Please refer to our website at www.nilfisk.com for further instructions and information on use.

Spare Part List

No.	Qty	Description
1	1	Active Nozzle VU200 dark blue
2	1	Tube dark blue
3	1	2x Small wheels
4	1	Dust bin module bright blue without label
5	1	Cyclone filter module black
6	1	Dust Bin filter
7	1	Main body module dark blue
8	1	Seal Rings
9	1	Hard floor roller VU200
10	1	Carpet roller VU200
11	1	Crevice tool S black
12	1	Combi brush S black
13	1	Hook and brackets
14	1	Sofa Brush S black
15	1	Brush S black
16	1	Flexible hose S black
17	1	Active brush S black
18	1	Wall mount S black
19	1	HEPA 14
20	1	Battery VU200
21	1	Charger S and plugs

Technical Data

Color	Dark blue
Plug type	EU/AU/UK/US
Voltage/frequency (V)	29.6
Battery run time ECO (min)	60
Battery run time normal (min)	25
Battery run time Turbo (min)	12
Max. power (W)	550
Battery capacity (mAh)	2500
Battery type	Li-ion
Battery power (W)	32 Max
Charging time (min)	1hr 50min
Container capacity (L)	0.8
Length x width x height (mm)	859.5 x 244.5 x 194
Weight (kg)	6.95
Sound pressure level as per EN 60335-2-69/uncertainty K	≤ 76 dB/2 dB
Sound power level as per EN 60335-2-69/uncertainty K	≤ 82 dB(A)/2 dB(A)
Vibration value as per EN 60335-2-69/uncertainty K	Handle < 2.5 m/s ² /1.5 m/s ²